

Disclaimer
 MAXWELL makes every effort to ensure the quality of the information available on this plan. Before relying on the information on this plan, users should carefully evaluate its accuracy, currency, completeness & relevance for their purpose, and should obtain any appropriate professional advice relevant to their particular circumstances. MAXWELL cannot guarantee and assumes no responsibility for the accuracy, currency or completeness of the information, and by using this plan you accept that MAXWELL has no liability for any loss or damage in any form whatsoever caused directly or indirectly from the use of this plan.

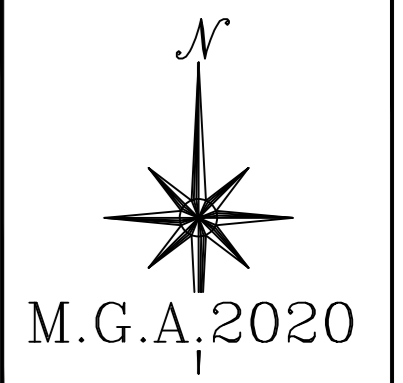

LEGEND

- Mining Tenement Boundary
- Existing Post Mining Landform
- Final Landform
- Cross Section Lines (See Plan 2 for locations)

Descriptions based on Plan 3A/B

- Legacy Open Cut Mining Area
- Water Management Area
- Infrastructure Area
- Tailings Emplacement Area
- Final Rehabilitation Area - Pasture
- Final Rehabilitation Area - Woodland

Note
 No coal extraction can occur under PA 06_0202.
 No coal extraction proposed during the MOP term under SSD 9526.

Location Plan of Cross Sections

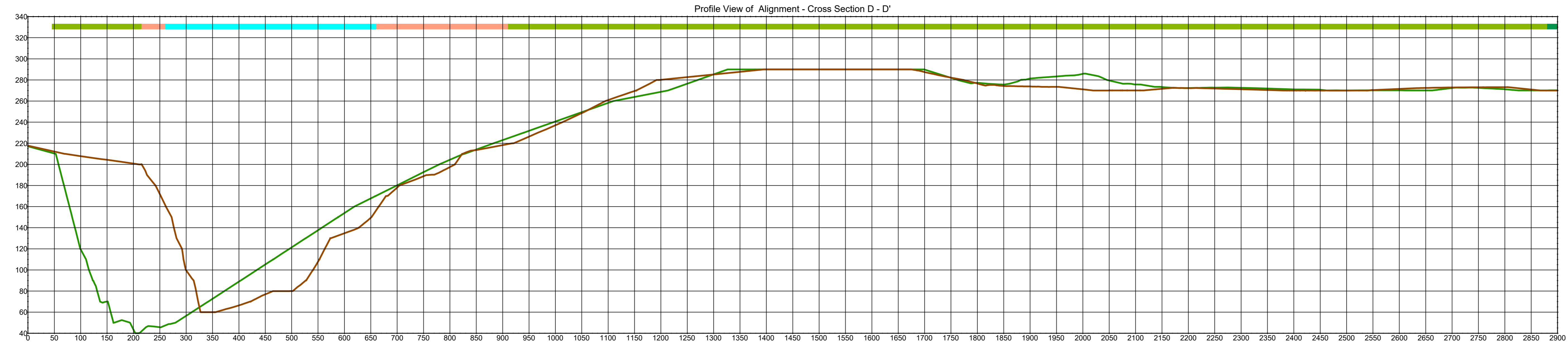
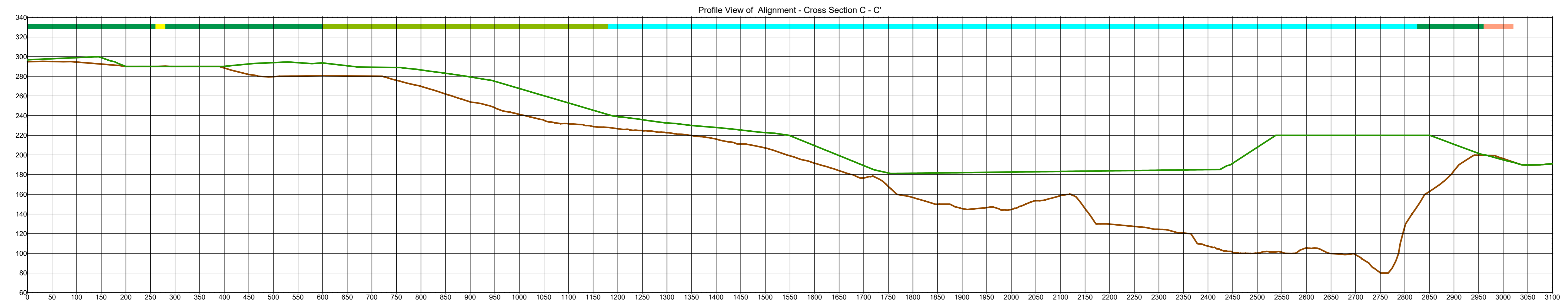
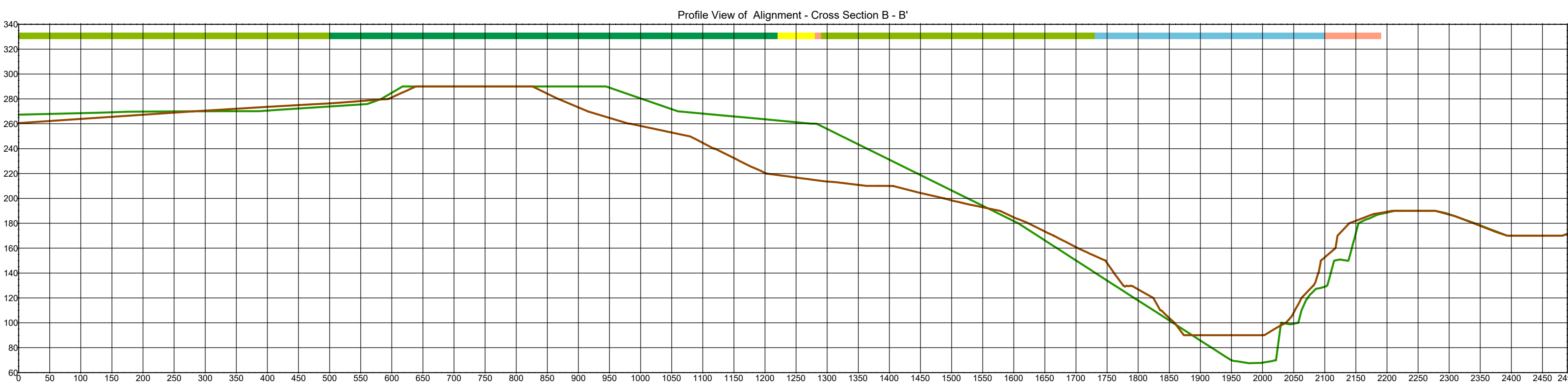
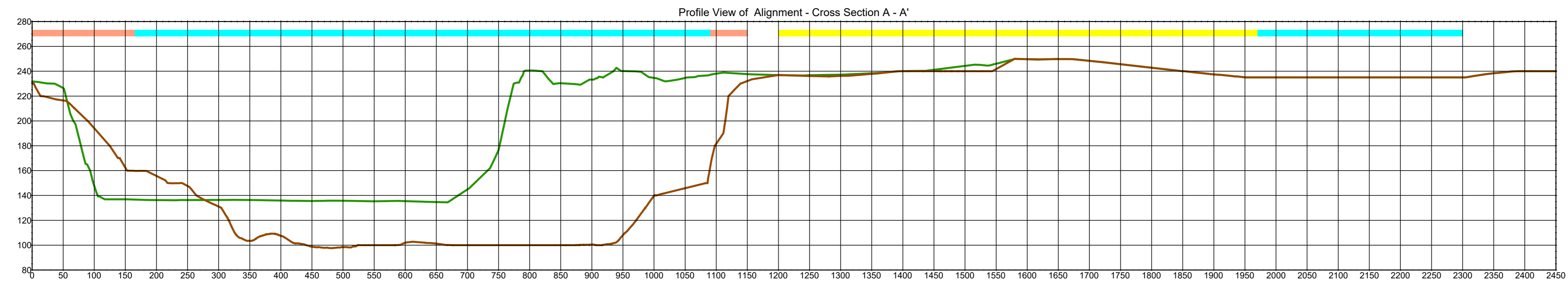
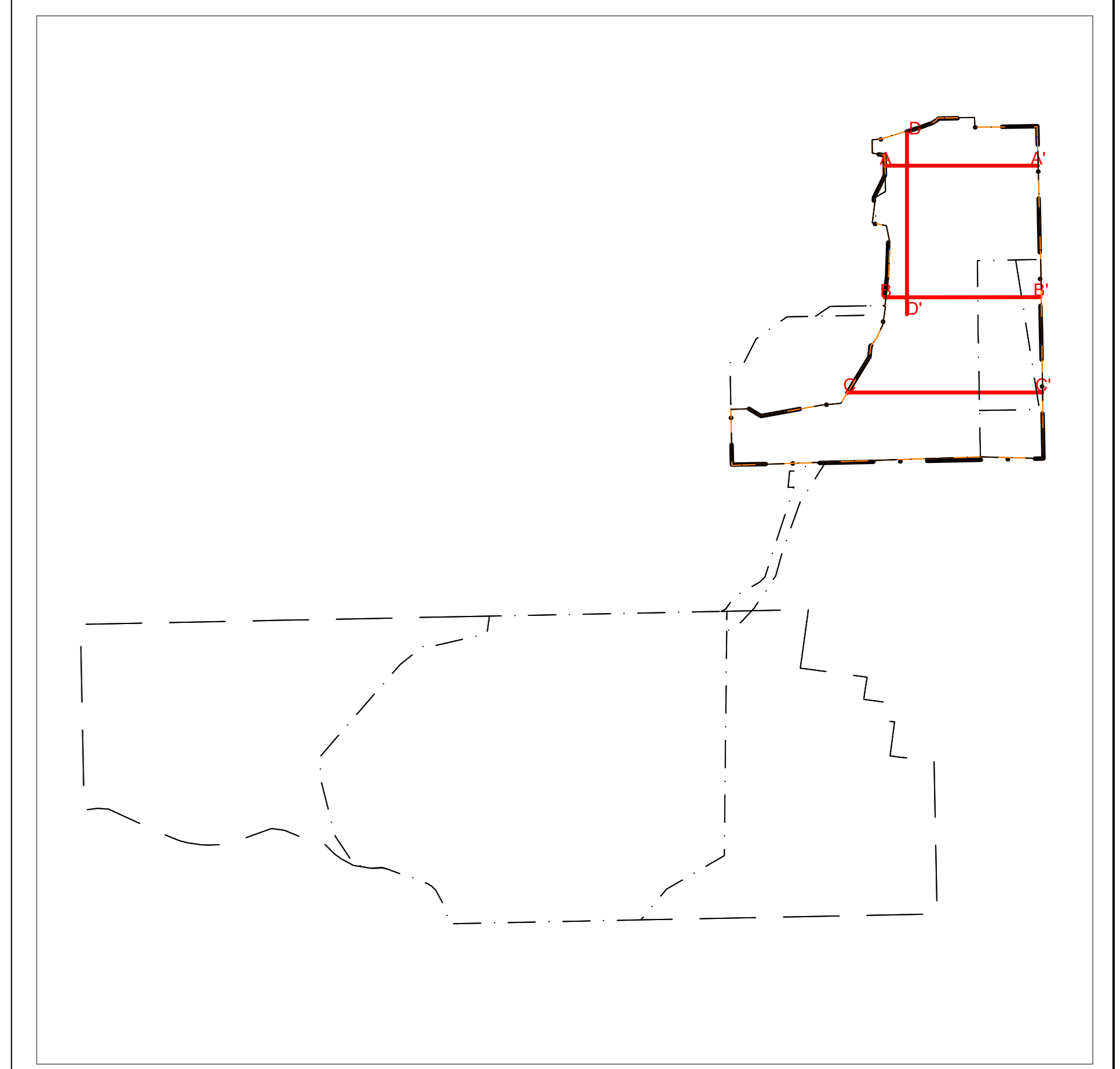

I, Robert Hayes, certify that the information on this plan is a true indication of the proposed development.

Robert Hayes 13/12/2021
 Manager of Mining Engineering Date
 (Practising Certificate No 2017-0280)

I, Andrew Boardman, certify that to the best of my knowledge and belief that the Mine Workings information shown on this plan is spatially correct.

Andrew Boardman 13/12/2021
 Registered Mining Surveyor Date
 (BOSSI Id No: 8527)

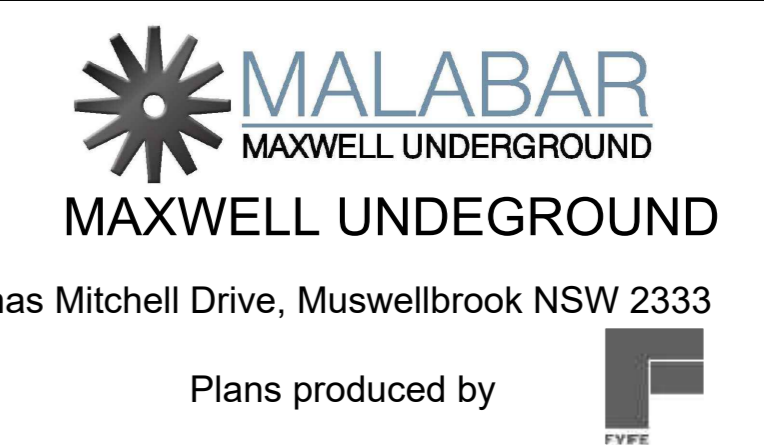

SCALE:	Various
DRAWN:	T.C.D.S.
CHECKED:	D.McL.
DATE:	December 2021
PLAN NUMBER :	Plan 5-MGA2020

DRAWING NAME: **MINING OPERATIONS PLAN**
Plan 5 - Rehabilitation & Post Mining Land Use Cross Sections
 Application Date - December 2021